

Contents

2x Steel brackets
 2x Support clips
 2x Washers
 2x Plastic wheels
 2x Axle bolts
 2x Nyloc axle nuts
 2x Axle cylinders
 2x Plastic protection covers

2 Adjustable wrenches
 required (not included)



1 Insert the axle bolt through axle cylinder then through plastic wheel and through the correct hole of the steel bracket

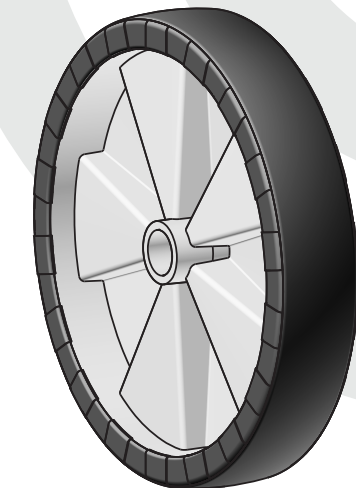
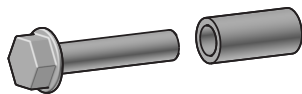

4 Place steel bracket with wheel assembly on to the bicycle wheel axle through the hole & support clip over the steel bracket

Replace the bicycle axle nut and tighten securely. The training wheels must have 6-10mm from the ground

Axle nut must be fully engaged on the axle. If this is not the case then an axle extender may be required (available separately)

5

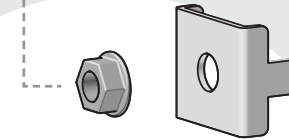

2

Place the washer and tighten with nyloc axle nut securely

6

Place the plastic protection cover at the top of the steel bracket



3

Remove bicycle wheel axle nut from the rear wheel of the cycle

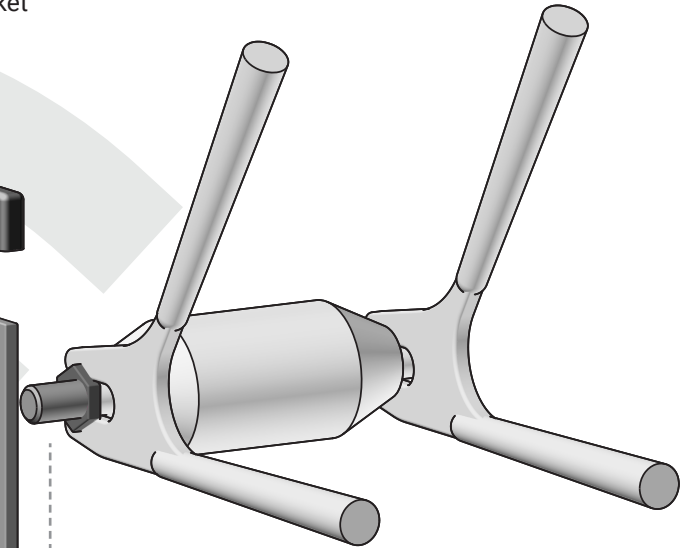

WARNING!

MAKE SURE THAT THE TRAINING WHEELS ARE FIXED PROPERLY BEFORE EVERY RIDE.

IMPORTANT

- ALL FASTENERS MUST BE CHECKED CAREFULLY TO ENSURE THEY ARE SECURE.
- THE STABILIZERS REQUIRE 20MM OF FREE AXLE LENGTH ON EACH SIDE OF THE CYCLE FOR A CORRECT FIT.
- CHOOSE THE CORRECT SIZE OF THE WHEEL (SEE PICTURE).

GC ACCESSORIES®

INSTALLATION MANUAL FOR
TRAINING WHEELS
20"

MADE IN GREECE

ΒΙΟΤΕΧΝΙΑ ΠΛΑΣΤΙΚΩΝ ΕΙΔΩΝ, ΣΧΑΡΕΣ ΠΟΔΗΛΑΤΟΥ - ΑΥΤΟΚΙΝΗΤΟΥ
ΛΕΩΦΟΡΟΣ Κ. ΚΑΡΑΜΑΝΛΗ 220 ΑΧΑΡΝΕΣ, Τ.Κ. 13678